

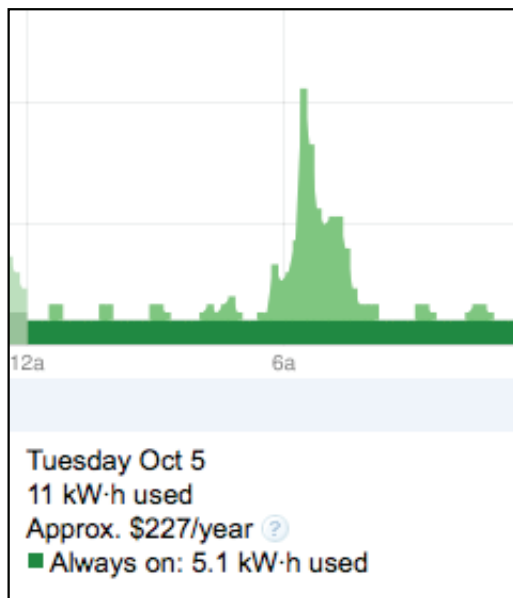

Annotated Real-Time Electricity Use Display for Addison Fox Household

October 5, 2010



Times are approximate:

4:50 a.m. furnace (heats hot water)

5:50 a.m. 1st shower, bathroom lights and fan, invisible fence (for dog)

6:05 a.m. 2nd shower, bathroom lights and fan, invisible fence (for dog), hair dryer, curling brush,

6:20 a.m. 3rd shower, bathroom lights and fan, invisible fence (for dog), kitchen lights on

6:30 a.m. shower continues..., bathroom lights and fan, invisible fence (for dog), kitchen lights on, coffeemaker (10 minute brew time), toaster, TV

7:00 a.m. bathroom lights and fan off, kitchen lights on

7:10 a.m. bathroom lights and fan on, kitchen lights on

7:40 a.m. coffee maker off, TV off, invisible fence off, all lights off

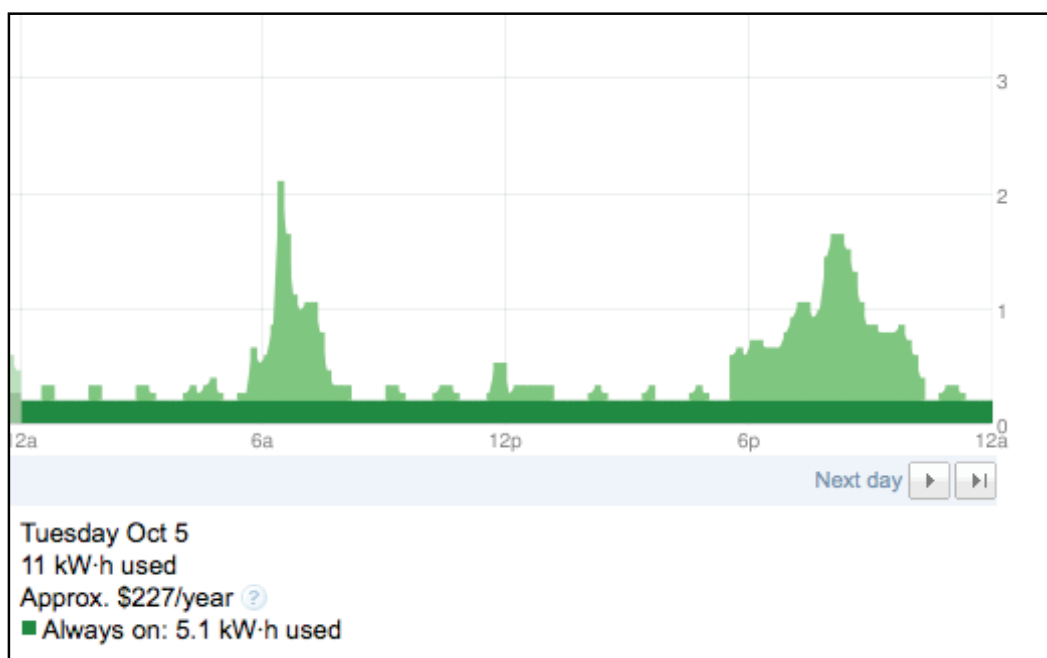



Two Views, Same Data

Below are two real-time electricity use graphs for the same day and time period. The top display shows data collected in 1 hour intervals from a Bangor Hydro Smart Meter. The second display shows data collected every 10 minutes from a TED and graphed by Google Power Meter. What similarities and differences do you notice? What are the advantages and limitations of each view? What would you like to see included in an “ideal” display?

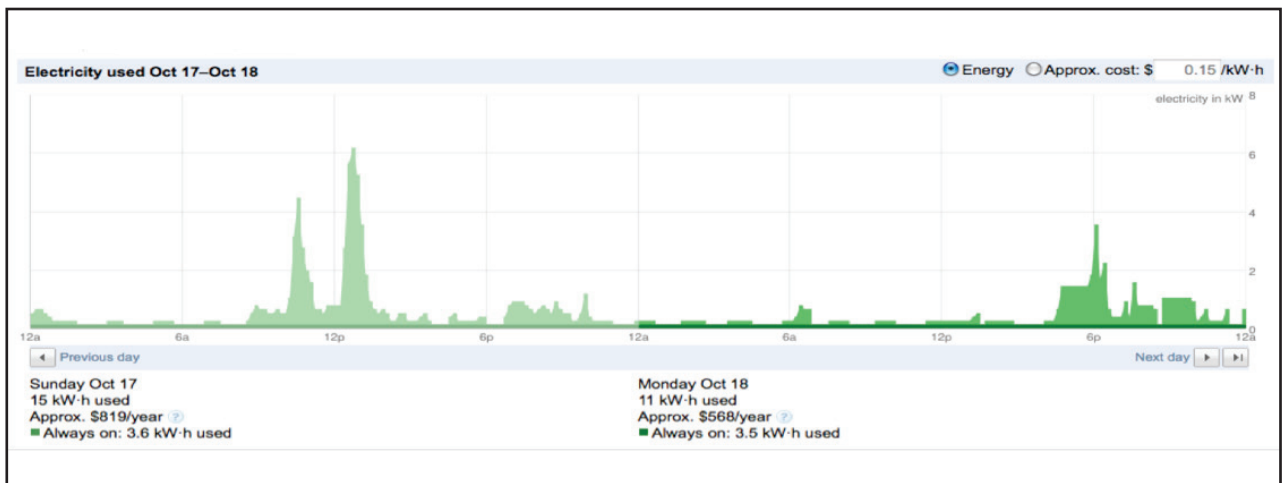
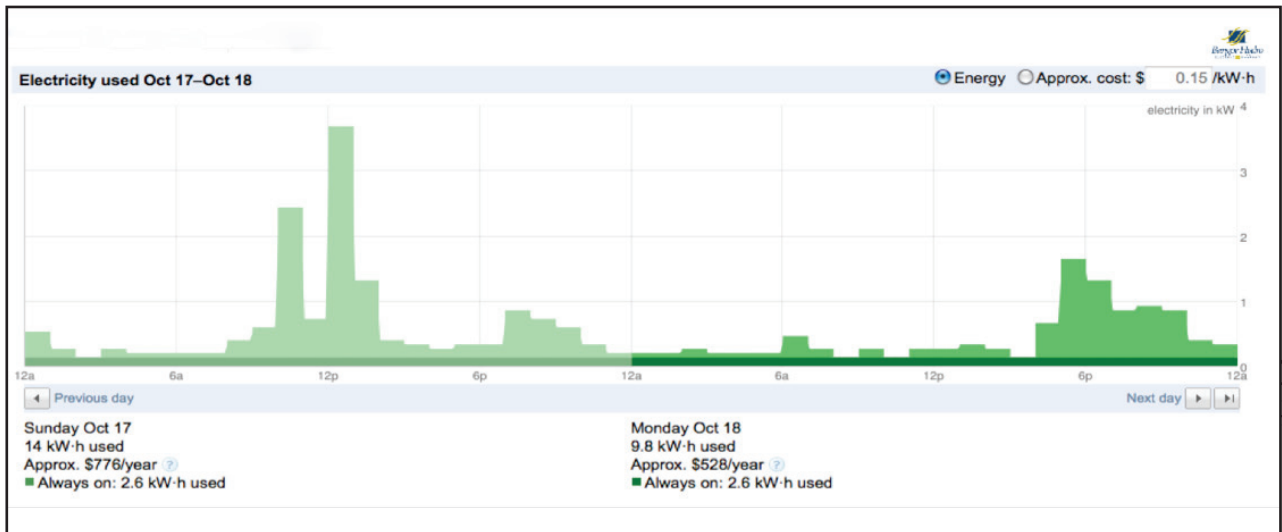



Home Specification Sheet for Addison Fox



Property Location: mid-coast Maine

Style: Two-story cape with porch and attached garage

Exterior Dimensions: 30' x 36'

Features

- Built in 1994
- Cedar sided exterior
- Full cement foundation
- 3 bedrooms / 2 baths
- 4 person dwelling
(2 adults; 2 teens)

Heating / Cooling Systems

- Oil (hot water baseboard)
- Hot water from furnace
- Back up woodstove (basement)
- Open hearth fireplace (first floor)
- No central or window unit air conditioning

Insulation

- Walls – fiberglass 6" R19
- Attic – 50% two layers of 6-8" R19; 50% three layers of 6-8" R19

Annual energy use

- Electricity (2010) – 7717 kilowatt hours
- Oil (2010) – approximately 650 gallons #2 heating oil

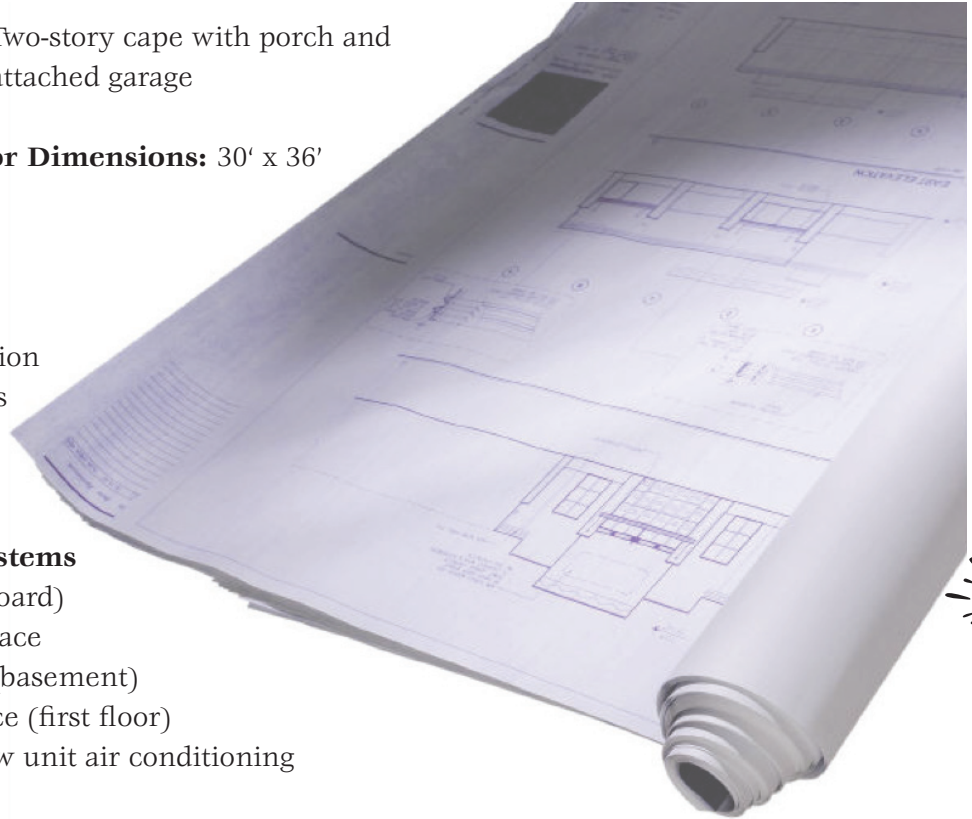



Living Space Detail • *Ceiling height 8' each level

	Dimensions	Appliances	Lighting / Other
First floor:			
Kitchen	12' x 12'3"	Refrigerator (1994) Electric stove (1994) Microwave (1994) Dishwasher (2005)	6 recessed ceiling lights (CFL) 1 under counter (florescent) 1 range light (incandescent) with ventilation hood
Dining / Living	13'9" x 29'	TV (cathode ray)	1 hanging light fixture (1 CFL) 2 tabletop lamps (1 CFL each) 1 floor lamp (1 CFL) 55 gallon fish tank with pump and heater electric dog wireless fence base unit
Mud room/ Laundry	8' x 5'6"	Front loading washer (2010) Electric dryer (1994)	2 recessed ceiling lights (CFL)
Bathroom (sink, toilet, shower)			1 ceiling light / fan (incandescent) Vanity lighting (3CFLs)
Den	13'9" X 11	TV (cathode ray) Satellite cable box DVD player Wireless internet router	2 recessed ceiling lights (CFL) 2 under counter (florescent) 1 floor lamp (1 CFL)
Entry / stairs			2 ceiling light fixtures /(4 incandescent bulbs) 1 fluorescent closet light
Second floor:			
Bedroom 1	15' X 16'6"		1 overhead ceiling light (2 CFLs) 1 recessed ceiling light (CFL) 3 tabletop lamps (1 CFL each) 1 fluorescent closet light
Bedroom 2	13' x 11'6"	TV (cathode ray) Gaming system Sound system	1 overhead ceiling light (2 CFLs) 1 fluorescent closet light
Bedroom 3	11'3" x 12'6"	TV (LED) Gaming system DVD player	1 overhead ceiling light (2 CFLs) 1 recessed ceiling light (CFL) 2 tabletop lamps (CFL) 1 fluorescent closet light
Bathroom (double sink, toilet, shower, whirlpool tub)			1 overhead ceiling light (2 CFLs) with ventilation fan 2 recessed ceiling lights (CFL) vanity lighting (8 CFLs)
Basement (partially finished)	13'9" x 29'	TV (cathode ray) Satellite cable box Treadmill Furnace Hot water heater Upright freezer (not in use)	3 overhead ceiling lights (6 CFLs) 1 hallway light (1 incandescent) 1 fluorescent shop light (two tubes) 2 overhead ceiling lights (CFL)
Garage	23'4" x 21'4"		4 overhead lights (CFLs)
Unfinished attic			1 light fixture (incandescent)
Porch / entries			4 recessed lights (5 incandescent floods) 6 exterior light fixtures (6 incandescent) 4 outdoor floods (incandescent)
Other:			Water pump



Maine Saves Energy!



Scientist's Notebook

Scientist: _____



Maine Saves Energy

References and Resources

Achenbach, J. (2010 July). The 21st Century Grid. *National Geographic*. 218 (1) 118-138. Also available online at <http://ngm.nationalgeographic.com/2010/07/power-grid/achenbach-text>

American Association for the Advancement of Science (AAAS). (2009). *Benchmarks Online*. <http://www.project2061.org/publications/bsl/online/index.php?home=true>

Bangor Hydroelectric Power Company. <http://www.bhe.com/>

Central Maine Power Company. <http://www.cmpco.com/>

Council of Chief State School Officers and National Governors Association. (2010). *Common Core Standards for Mathematics*. http://www.corestandards.org/assets/CCSSI_Math%20Standards.pdf

Department of Energy. (2011). SmartGrid.gov. <http://www.smartgrid.gov/>

Energy Circle. (2009). Energy Monitoring. <http://www.energycircle.com/learn/energy-monitoring>

Energy, Inc. (2010). The Energy Detective (TED). <http://www.theenergydetective.com/>

Exploratorium Institute for Inquiry. (2006). *Raising Questions*. San Francisco, CA: Exploratorium.

Federal Trade Commission. (2010). Energy Guidance: Appliance Shopping With the Energy Guide Label. <http://www.ftc.gov/bcp/edu/pubs/consumer/homes/rea14.shtm>



Keeley, P. (2008). *Science Formative Assessment: 75 Practical Strategies for Linking Assessment, Instruction, and Learning*. Thousand Oaks, CA: Corwin Press.

Klentschy, M. (2010). *Using Science Notebooks in Middle School*. Arlington, VA: NSTA Press.

Llewellyn, D. (2002). *Inquire Within. Implementing Inquiry-Based Science Standards*. Thousand Oaks, CA: Corwin Press.

Maine Department of Education. (2007). *Maine's Learning Results*. Augusta, ME.
<http://www.maine.gov/education/lres/pei/index.html>

Maine Public Service. How to Read Your Electric Meter.
<http://www.mainepublicservice.com/education/electricity-education.aspx>

Michigan State University. (2009). *Connected Mathematics 2: Variables and Patterns*. New York, NY: Pearson Education.

National Research Council. (1996). *National Science Education Standards*. Washington, DC: National Academy Press.

North Carolina University. (2010). *Sustainable Transportation Education Program*. Middle School Pilot. [152.1.103.103/units/STEP/STEP_MS_Units_2.25.pdf](http://www.ncsu.edu/STEP/STEP_MS_Units_2.25.pdf)

Pennsylvania Weatherization Providers. (2011). *End Uses of Energy in the Home*. <http://www.pasolar.ncat.org/lesson01.php>

TERC. (2004). *Investigations in Number, Data, and Space. Changes Over Time*. New York, NY: Scott Foresman / Pearson Education.

Troast, P. (2009). Real-Time Electricity Monitoring Works (24 Hours Later Doesn't).
<http://www.energycircle.com/blog/2009/07/07/real-time-electricity-monitoring-works-24-hours-later-doesnt>

